

# DC24V WASHER LIGHT INSTALLATION

1. Punch on the surfacemounting and insert the rubber plug

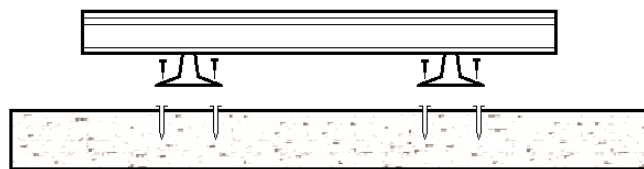

2. Installed the wall washer light and fix the mounting base with screws

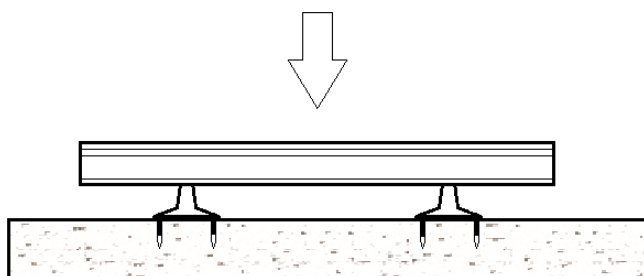

1. If you encounter a place such as glass that cannot be punched, do not use glue or other direct fixing. It must be erected with iron frame or aluminum frame and screwed.

2. When the screw is fixed, the number of screws should not be reduced at random. It must be sufficient and tightened. The installation should be firm to ensure that the wall washer is well fixed and there is no looseness or movement.

3. During handling and construction, do not drop, throw, press, or wash the wall lamp body. Do not pull or bend the extension joints to avoid loosening the seal line and causing bad rain to enter the wall washer. Causes the lamp to be damaged.

4. The wall washer connection can be directly connected to the male and female connectors through its own male and female connectors. Before connecting, please check whether the waterproof ring connected to the male and female is installed properly. The maximum serial length of the wall washer should not exceed the nominal value. See the rear wiring diagram for details.

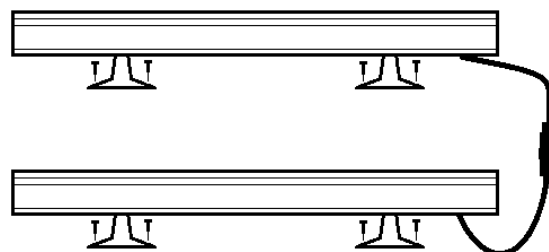

Note: 1. The power supply voltage and frequency must be the same as the wall washer (please refer to the wattage on the lamp), otherwise the wall will be burned out; 2. The number of consecutive wall-to-wall connections cannot exceed the maximum number of extensions (see Drawing), otherwise the power cord or fixture will be burnt.

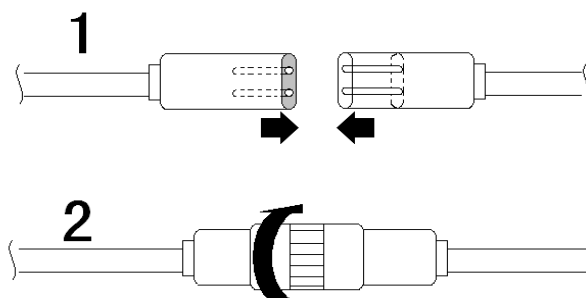

# DC24V WASHER LIGHT INSTALLATION

## Wall washer wiring diagram

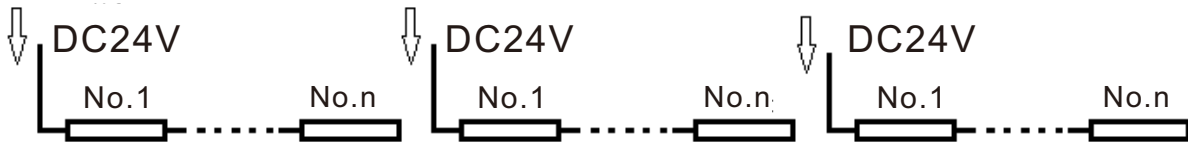

### Note:

- 1, wall washer power = 12W, the number of serial connections  $n = 12$ , when the number of wall washers connected more than 12, you need to increase the power input line, otherwise it will burn out the lamps;
  - 2, wall washer power = 15W, the number of serial connections  $n = 8$ , when the number of wall washers connected more than 8 need to increase the power input line, otherwise it will burn out the lamps;
  - 3, the power of the wall washer = 18W, the number of serial connections  $n = 6$ , when the number of series of wall washers exceeds 6, you need to increase the power input line, otherwise it will burn out the lamps;
  - 4, the power of the wall washer = 24W, the number of serial connections  $n = 4$ , the number of wall-mounted lamps connected in more than 4 need to increase the power input line, otherwise it will burn out the lamps;
  - 5, wall washer power = 36W, the number of serial connections  $n = 3$ , the number of wall-mounted lamps connected in more than 3 need to increase the power input line, otherwise it will burn out the lamps;
  - 6, the power of the wall washer = 48W, the number of serial connections  $n = 2$ , the number of wall-mounted lamps connected in more than 2 need to increase the power input line, otherwise it will burn out the lamps;
  - 7, wall washer power = 72W, the number of serial connections  $n = 1$ , each wall washer requires a separate power input line, otherwise it will burn out the fixture.
- Due to the large number of driver brands, we suggest that used the 85% power of the driver. .  
For example, the driver is 350W, then when you use it do not more than 300W.

### Notice:

1. The driver must be equipped with the corresponding overload protector and leakage switch for safety.
2. The air circulation should be ensured around the lamps (a certain space should be left before and after, left and right) to maintain a good heat dissipation effect.
- 3, please make a waterproof part of the wiring head: as shown below

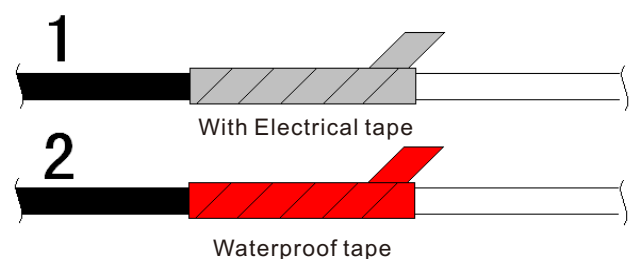

## DC24V WASHER LIGHT INSTALLATION

### Warning:

1. Be careful of leakage: In the place where the PVC pipe needs to be out, please use the three-way or outlet box. The cable must be sleeved with a snake-sleeve and tightly wrapped with waterproof tape. The size of the tee or the outlet box should be small enough to prevent the internal contact of the connecting part from being poorly connected or broken.

2. The connection and installation of the main power box must be very careful. If you choose a variety of light source products to install at the same time, please be sure to separate the circuit of the linear lamp from other lighting circuits, such as floodlights, underwater lights, aerial spotlights, street lights, etc. Connect and power up to avoid the impact of high currents. However, the linear light can be connected and powered up with the controller that is associated with her.

Although the linear lamp series uses a new generation of energy-saving light source LEDs as the illuminant, the single power is small, but the choice of wires and switches still needs attention, and the switches and protectors must be separately configured for the linear lamps. Please select the wire, switch, protector and other peripheral accessories of well-known brands that have passed the electrician certification, and pay close attention to the heat of the wire. There are precedents for faults and even product damage due to defects in the quality of the wires and switches, so be sure to take them seriously to avoid accidents.

3. The external flexible cable or cord of this luminaire cannot be replaced; if the cord is damaged, the luminaire will be scrapped. The light source of this luminaire is irreplaceable; when the light source reaches its end, it should replace the entire luminaire.